

**NOTE :-**

1. BUILDING WILL BE DESIGNED (STRUCTURES) AS PER RELEVANT IS CODES FOR EARTH QUAKE RESISTANCE.
2. THE BUILDING IS ARTIFICIALLY VENTILATED MECHANICALLY VENTILATED.

**LEGEND :-**

**PROJECT : THE ARBOUR**

REVISED (2nd Revision) BUILDING PLANS OF GROUP HOUSING COLONY AREA MEASURING 25.987 ACRES (LICENCE NO. 123 OF 2012 DATED 20-12-2012 IN SECTOR-63, Gurgaon) BEING DEVELOPED BY ARLE BUILDERS & DEVELOPERS PVT. LTD. AND OTHERS IN COLLABORATION WITH DLF HOME DEVELOPERS LTD (EARLIER KNOWN AS DLF NEW Gurgaon HOME DEVELOPERS PVT.LTD)

**ARCHITECTURE : AR COP**

AR COP ASSOCIATES PVT LTD  
Plot No. 36B, Sector-32, Institutional Area, Gurugram, Haryana. 122001, India  
Tel.: 91-124-4595500  
91-124-4595500  
Fax: 91-124-4595550

**ASSOCIATE ARCHITECTS**



RMS ARCHITECTS PVT. LTD.  
69, Nara Niwas, Bhawani Kunj  
(Behind D2), Vasant Kunj,  
New Delhi-110070.  
Tel.: 011-26888616, 26888617  
www.rsms-arch.com

This is a PROVISIONAL BUILDING PLAN  
This plan is subject to any  
objections from the general public  
within  
30 days from the date of  
issuance of this plan.

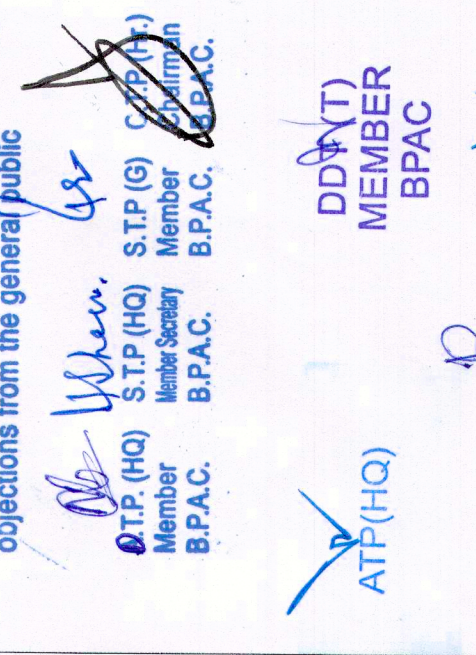

Checked and found ok for Public Health  
(Internal Service only subject to community)  
in forwarding letter No. 2383 S... dated 22/04/24

Superintending Engineer (HQ)  
Chief Engineer-I  
Haryana P.F. Chandigarh

MARCH - 2024 Scale : 1:200  
Drawing No. :- BS-05

BASEMENT-2(SOUTH-POCKET)  
UNDER TOWER D.E

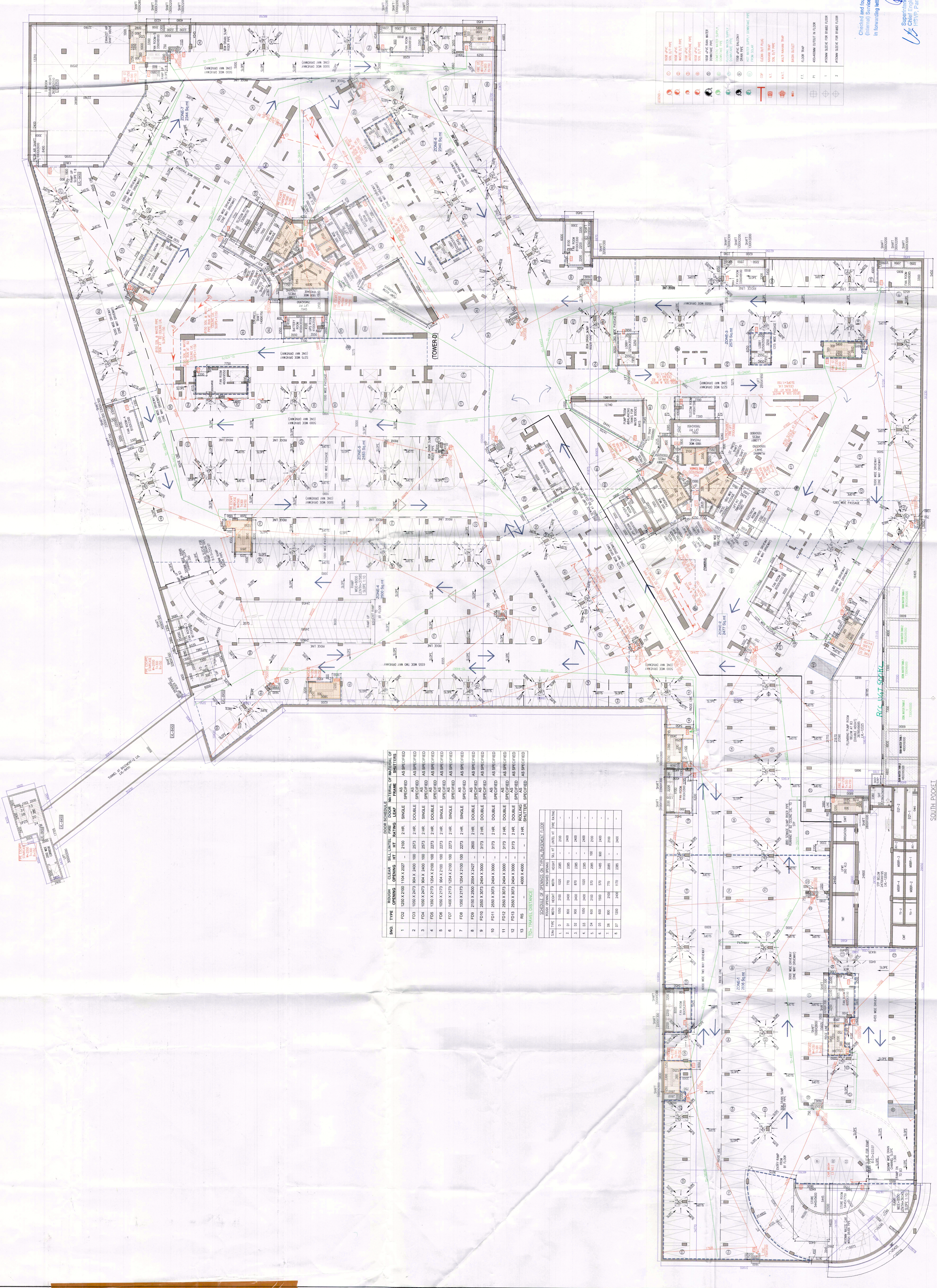

**SCHEDULE OF OPENINGS ON THE BASEMENT FLOOR**

Sl. No.	Room No.	Opening Type	Size (mm)	Material	Remarks
1	F01	DOOR	1000 X 2100	1100 X 2025	2 HR. SINGLE
2	F02	DOOR	1000 X 2100	1100 X 2025	2 HR. SINGLE
3	F03	DOOR	1000 X 2100	1100 X 2025	2 HR. SINGLE
4	F04	DOOR	1000 X 2100	1100 X 2025	2 HR. SINGLE
5	F05	DOOR	1000 X 2100	1100 X 2025	2 HR. SINGLE
6	F06	DOOR	1000 X 2100	1100 X 2025	2 HR. SINGLE
7	F07	DOOR	1000 X 2100	1100 X 2025	2 HR. SINGLE
8	F08	DOOR	1000 X 2100	1100 X 2025	2 HR. SINGLE
9	F09	DOOR	1000 X 2100	1100 X 2025	2 HR. SINGLE
10	F10	DOOR	1000 X 2100	1100 X 2025	2 HR. SINGLE
11	F11	DOOR	1000 X 2100	1100 X 2025	2 HR. SINGLE
12	F12	DOOR	1000 X 2100	1100 X 2025	2 HR. SINGLE
13	F13	DOOR	1000 X 2100	1100 X 2025	2 HR. SINGLE
14	F14	DOOR	1000 X 2100	1100 X 2025	2 HR. SINGLE
15	F15	DOOR	1000 X 2100	1100 X 2025	2 HR. SINGLE
16	F16	DOOR	1000 X 2100	1100 X 2025	2 HR. SINGLE
17	F17	DOOR	1000 X 2100	1100 X 2025	2 HR. SINGLE
18	F18	DOOR	1000 X 2100	1100 X 2025	2 HR. SINGLE
19	F19	DOOR	1000 X 2100	1100 X 2025	2 HR. SINGLE
20	F20	DOOR	1000 X 2100	1100 X 2025	2 HR. SINGLE

**SCHEDULE OF OPENINGS ON THE BASEMENT FLOOR**

Sl. No.	Room No.	Opening Type	Size (mm)	Material	Remarks
1	F01	DOOR	1000 X 2100	1100 X 2025	2 HR. SINGLE
2	F02	DOOR	1000 X 2100	1100 X 2025	2 HR. SINGLE
3	F03	DOOR	1000 X 2100	1100 X 2025	2 HR. SINGLE
4	F04	DOOR	1000 X 2100	1100 X 2025	2 HR. SINGLE
5	F05	DOOR	1000 X 2100	1100 X 2025	2 HR. SINGLE
6	F06	DOOR	1000 X 2100	1100 X 2025	2 HR. SINGLE
7	F07	DOOR	1000 X 2100	1100 X 2025	2 HR. SINGLE
8	F08	DOOR	1000 X 2100	1100 X 2025	2 HR. SINGLE
9	F09	DOOR	1000 X 2100	1100 X 2025	2 HR. SINGLE
10	F10	DOOR	1000 X 2100	1100 X 2025	2 HR. SINGLE
11	F11	DOOR	1000 X 2100	1100 X 2025	2 HR. SINGLE
12	F12	DOOR	1000 X 2100	1100 X 2025	2 HR. SINGLE
13	F13	DOOR	1000 X 2100	1100 X 2025	2 HR. SINGLE
14	F14	DOOR	1000 X 2100	1100 X 2025	2 HR. SINGLE
15	F15	DOOR	1000 X 2100	1100 X 2025	2 HR. SINGLE
16	F16	DOOR	1000 X 2100	1100 X 2025	2 HR. SINGLE
17	F17	DOOR	1000 X 2100	1100 X 2025	2 HR. SINGLE
18	F18	DOOR	1000 X 2100	1100 X 2025	2 HR. SINGLE
19	F19	DOOR	1000 X 2100	1100 X 2025	2 HR. SINGLE
20	F20	DOOR	1000 X 2100	1100 X 2025	2 HR. SINGLE

SOUTH POCKET  
BASEMENT-2  
L.V.-8450

DATE: 22/04/24  
SCALE: 1:200