

Note :-

1. BUILDING WILL BE DESIGNED (STRUCTURES) AS PER RELEVANT IS CODES FOR EARTH QUAKE RESISTANCE.
2. THE BUILDING IS ARTIFICIALLY LIT AND MECHANICALLY VENTILATED.

LEGEND:-

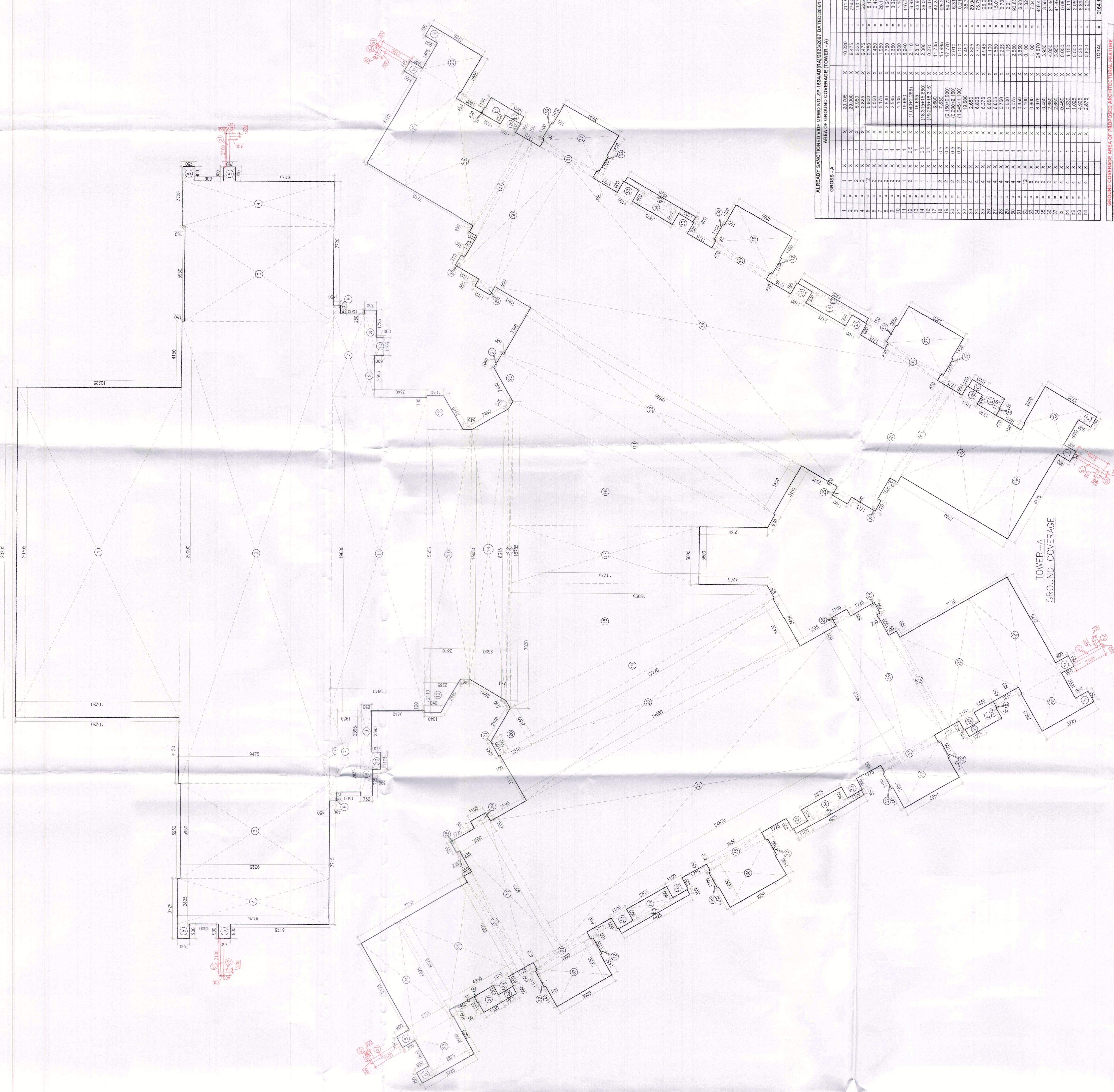

ALREADY SANCTIONED WIDE MEMO NO. ZP-1524/AD(RA)/2023/2037 DATED 20-01-2023
AREA OF GROUND COVERAGE (TOWER - A)

Sl. No.	Particulars	Area (sqm)
1	1	11,796.50
2	2	11,796.50
3	3	11,796.50
4	4	11,796.50
5	5	11,796.50
6	6	11,796.50
7	7	11,796.50
8	8	11,796.50
9	9	11,796.50
10	10	11,796.50
11	11	11,796.50
12	12	11,796.50
13	13	11,796.50
14	14	11,796.50
15	15	11,796.50
16	16	11,796.50
17	17	11,796.50
18	18	11,796.50
19	19	11,796.50
20	20	11,796.50
21	21	11,796.50
22	22	11,796.50
23	23	11,796.50
24	24	11,796.50
25	25	11,796.50
26	26	11,796.50
27	27	11,796.50
28	28	11,796.50
29	29	11,796.50
30	30	11,796.50
31	31	11,796.50
32	32	11,796.50
33	33	11,796.50
34	34	11,796.50
35	35	11,796.50
36	36	11,796.50
37	37	11,796.50
38	38	11,796.50
39	39	11,796.50
40	40	11,796.50
41	41	11,796.50
42	42	11,796.50
43	43	11,796.50
44	44	11,796.50
45	45	11,796.50
46	46	11,796.50
47	47	11,796.50
48	48	11,796.50
49	49	11,796.50
50	50	11,796.50
51	51	11,796.50
52	52	11,796.50
53	53	11,796.50
54	54	11,796.50
55	55	11,796.50
56	56	11,796.50
57	57	11,796.50
58	58	11,796.50
59	59	11,796.50
60	60	11,796.50
61	61	11,796.50
62	62	11,796.50
63	63	11,796.50
64	64	11,796.50
65	65	11,796.50
66	66	11,796.50
67	67	11,796.50
68	68	11,796.50
69	69	11,796.50
70	70	11,796.50
71	71	11,796.50
72	72	11,796.50
73	73	11,796.50
74	74	11,796.50
75	75	11,796.50
76	76	11,796.50
77	77	11,796.50
78	78	11,796.50
79	79	11,796.50
80	80	11,796.50
81	81	11,796.50
82	82	11,796.50
83	83	11,796.50
84	84	11,796.50
85	85	11,796.50
86	86	11,796.50
87	87	11,796.50
88	88	11,796.50
89	89	11,796.50
90	90	11,796.50
91	91	11,796.50
92	92	11,796.50
93	93	11,796.50
94	94	11,796.50
95	95	11,796.50
96	96	11,796.50
97	97	11,796.50
98	98	11,796.50
99	99	11,796.50
100	100	11,796.50
101	101	11,796.50
102	102	11,796.50
103	103	11,796.50
104	104	11,796.50
105	105	11,796.50
106	106	11,796.50
107	107	11,796.50
108	108	11,796.50
109	109	11,796.50
110	110	11,796.50
111	111	11,796.50
112	112	11,796.50
113	113	11,796.50
114	114	11,796.50
115	115	11,796.50
116	116	11,796.50
117	117	11,796.50
118	118	11,796.50
119	119	11,796.50
120	120	11,796.50
121	121	11,796.50
122	122	11,796.50
123	123	11,796.50
124	124	11,796.50
125	125	11,796.50
126	126	11,796.50
127	127	11,796.50
128	128	11,796.50
129	129	11,796.50
130	130	11,796.50
131	131	11,796.50
132	132	11,796.50
133	133	11,796.50
134	134	11,796.50
135	135	11,796.50
136	136	11,796.50
137	137	11,796.50
138	138	11,796.50
139	139	11,796.50
140	140	11,796.50
141	141	11,796.50
142	142	11,796.50
143	143	11,796.50
144	144	11,796.50
145	145	11,796.50
146	146	11,796.50
147	147	11,796.50
148	148	11,796.50
149	149	11,796.50
150	150	11,796.50
151	151	11,796.50
152	152	11,796.50
153	153	11,796.50
154	154	11,796.50
155	155	11,796.50
156	156	11,796.50
157	157	11,796.50
158	158	11,796.50
159	159	11,796.50
160	160	11,796.50
161	161	11,796.50
162	162	11,796.50
163	163	11,796.50
164	164	11,796.50
165	165	11,796.50
166	166	11,796.50
167	167	11,796.50
168	168	11,796.50
169	169	11,796.50
170	170	11,796.50
171	171	11,796.50
172	172	11,796.50
173	173	11,796.50
174	174	11,796.50
175	175	11,796.50
176	176	11,796.50
177	177	11,796.50
178	178	11,796.50
179	179	11,796.50
180	180	11,796.50
181	181	11,796.50
182	182	11,796.50
183	183	11,796.50
184	184	11,796.50
185	185	11,796.50
186	186	11,796.50
187	187	11,796.50
188	188	11,796.50
189	189	11,796.50
190	190	11,796.50
191	191	11,796.50
192	192	11,796.50
193	193	11,796.50
194	194	11,796.50
195	195	11,796.50
196	196	11,796.50
197	197	11,796.50
198	198	11,796.50
199	199	11,796.50
200	200	11,796.50
201	201	11,796.50
202	202	11,796.50
203	203	11,796.50
204	204	11,796.50
205	205	11,796.50
206	206	11,796.50
207	207	11,796.50
208	208	11,796.50
209	209	11,796.50
210	210	11,796.50
211	211	11,796.50
212	212	11,796.50
213	213	11,796.50
214	214	11,796.50
215	215	11,796.50
216	216	11,796.50
217	217	11,796.50
218	218	11,796.50
219	219	11,796.50
220	220	11,796.50
221	221	11,796.50
222	222	11,796.50
223	223	11,796.50
224	224	11,796.50
225	225	11,796.50
226	226	11,796.50
227	227	11,796.50
228	228	11,796.50
229	229	11,796.50
230	230	11,796.50
231	231	11,796.50
232	232	11,796.50
233	233	11,796.50
234	234	11,796.50
235	235	11,796.50
236	236	11,796.50
237	237	11,796.50
238	238	11,796.50
239	239	11,796.50
240	240	11,796.50
241	241	11,796.50
242	242	11,796.50
243	243	11,796.50
244	244	11,796.50
245	245	11,796.50
246	246	11,796.50
247	247	11,796.50
248	248	11,796.50
249	249	11,796.50
250	250	11,796.50
251	251	11,796.50
252	252	11,796.50
253	253	11,796.50
254	254	11,796.50
255	255	11,796.50
256	256	11,796.50
257	257	11,796.50
258	258	11,796.50
259	259	11,796.50
260	260	11,796.50
261	261	11,796.50
262	262	11,796.50
263	263	11,796.50
264	264	11,796.50
265	265	11,796.50
266	266	11,796.50
267	267	11,796.50
268	268	11,796.50
269	269	11,796.50
270	270	11,796.50
271	271	11,796.50
272	272	11,796.50
273	273	11,796.50
274	274	11,796.50
275	275	11,796.50
276	276	11,796.50
277	277	11,796.50
278	278	11,796.50
279	279	11,796.50
280	280	11,796.50
281	281	11,796.50
282	282	11,796.50
283	283	11,796.50
284	284	11,796.50
285	285	11,796.50
286	286	11,796.50
287	287	11,796.50
288	288	11,796.50
289	289	11,796.50
290	290	11,796.50
291	291	11,796.50
292	292	11,796.50
293	293	11,796.50
294	294	11,796.50
295	295	11,796.50
296	296	11,796.50
297	297	11,796.50
298	298	11,796.50
299	299	11,796.50
300	300	11,796.50
301	301	11,796.50
302	302	11,796.50
303	303	11,796.50
304	304	11,796.50
305	305	11,796.50
306	306	11,796.50
307	307	11,796.50
308	308	11,796.50
309	309	11,796.50
310	310	11,796.50
311	311	11,796.50
312	312	11,796.50
313	313	11,796.50
314	314	11,796.50
315	315	11,796.50
316	316	11,796.50
317	317	11,796.50
318	318	11,796.50
319	319	11,796.50
320	320	11,796.50
321	321	11,796.50
322	322	11,796.50
323	323	11,796.50
324	324	11,796.50
325	325	11,796.50
326	326	11,796.50
327	327	11,796.50
328	328	11,796.50
329	329	11,796.50
330	330	11,796.50
331	331	11,796.50
332	332	11,796.50
333	333	11,796.50
334	334	11,796.50
335	335	11,796.50
336	336	11,796.50
337	337	11,796.50
338	338	11,796.50
339	339	11,796.50
340	340	11,796.50
341	341	11,796.50
342	342	11,796.50
343	343	11,796.50
344	344	11,796.50
345	345	11,796.50
346	346	