

Note :-

1. BUILDING WILL BE DESIGNED (STRUCTURES) AS PER RELEVANT IS CODES FOR EARTH QUAKE RESISTANCE.
2. THE BUILDING IS ARTIFICIALLY LIT AND MECHANICALLY VENTILATED.

LEGEND:-

PROJECT :

REVISED BUILDING PLANS OF GROUP HOUSING COLONY AREA MEASURING 25.087 ACRES LICENCE NO. 123 OF 2012 DATED 20-12-2012 IN SECTOR-63, GURGAON BEING DEVELOPED BY ARIE BUILDERS & DEVELOPERS PVT. LTD. AND OTHERS IN COLLABORATION WITH DLF HOME DEVELOPERS LTD/DEARER KNOWAS DLF NEW GURGAON HOME DEVELOPERS PVT.LTD)

ARCHITECTURE:

ARCOP

ARCOP ASSOCIATES PVT LTD
Plot No. 36B, Sector-32, Institutional Area, Gurugram, Haryana, 122001, India
Tel: 91-124-4595500
Fax: 91-124-4595550

TO BE READ WITH THIS OFFICE DRAWING NO. 20-01-2023 DATED: 20-01-2023

OWNER'S SEAL & SIGNATURE
DLF Home Developers Limited
Prateek Bhatnagar
Project No: 123020027

JAN - 2023. Scale : 1:200
Drawing No. - BS-03
BASEMENT-(PART-1)

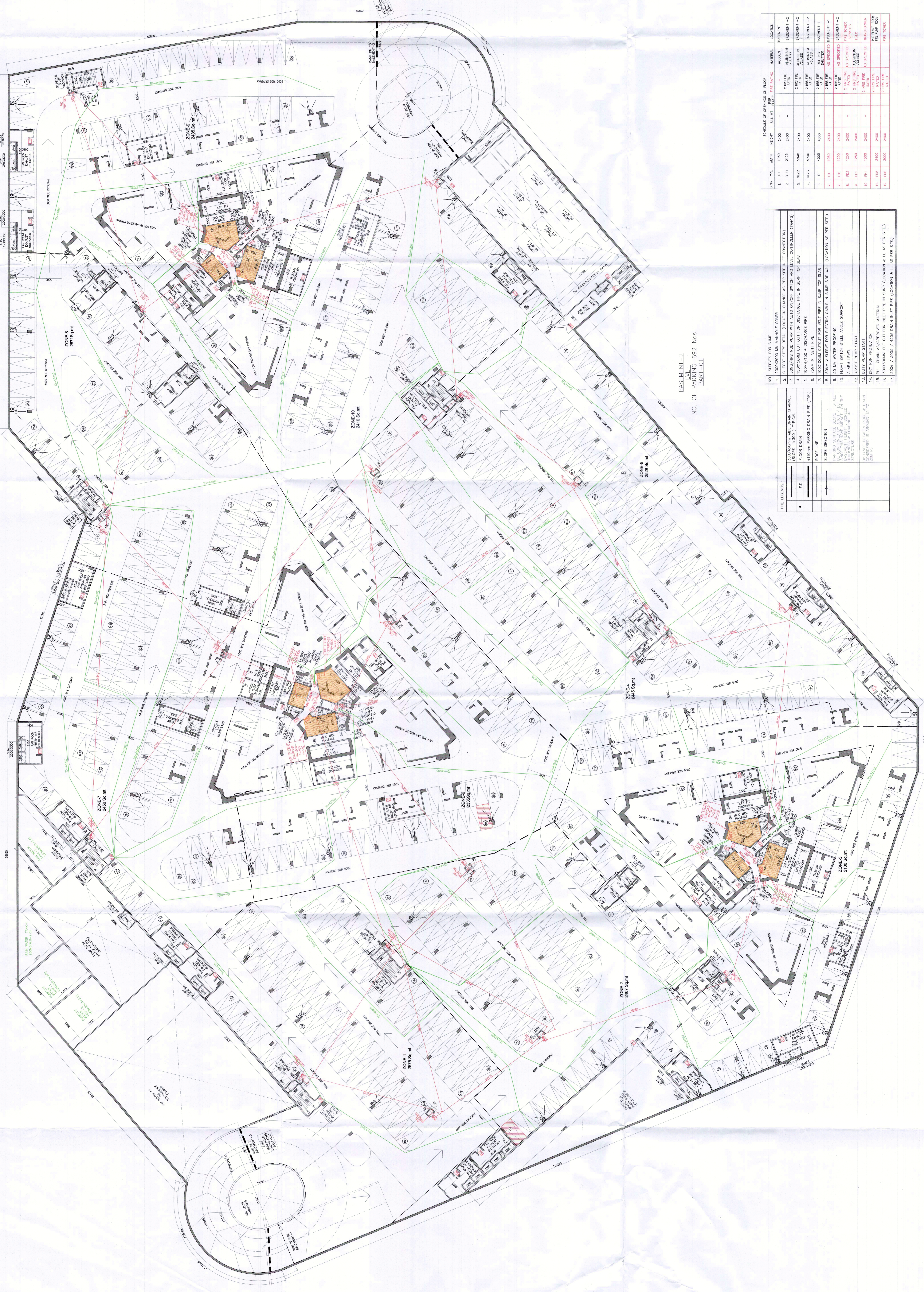

NO. SIZES FOR SUMP

1. 300/450mm WIRE DRAIN CHANNEL (EXCISE 1:300) TYPICAL
2. 150mm WIRE DRAIN CHANNEL (EXCISE 1:300) TYPICAL
3. 150mm WIRE DRAIN CHANNEL (EXCISE 1:300) TYPICAL
4. 150mm WIRE DRAIN CHANNEL (EXCISE 1:300) TYPICAL
5. 150mm WIRE DRAIN CHANNEL (EXCISE 1:300) TYPICAL
6. 150mm WIRE DRAIN CHANNEL (EXCISE 1:300) TYPICAL
7. 150mm WIRE DRAIN CHANNEL (EXCISE 1:300) TYPICAL
8. 150mm WIRE DRAIN CHANNEL (EXCISE 1:300) TYPICAL
9. 150mm WIRE DRAIN CHANNEL (EXCISE 1:300) TYPICAL
10. 150mm WIRE DRAIN CHANNEL (EXCISE 1:300) TYPICAL
11. 150mm WIRE DRAIN CHANNEL (EXCISE 1:300) TYPICAL
12. 150mm WIRE DRAIN CHANNEL (EXCISE 1:300) TYPICAL
13. 150mm WIRE DRAIN CHANNEL (EXCISE 1:300) TYPICAL
14. 150mm WIRE DRAIN CHANNEL (EXCISE 1:300) TYPICAL
15. 150mm WIRE DRAIN CHANNEL (EXCISE 1:300) TYPICAL
16. 150mm WIRE DRAIN CHANNEL (EXCISE 1:300) TYPICAL
17. 150mm WIRE DRAIN CHANNEL (EXCISE 1:300) TYPICAL

SCHEDULE OF MATERIALS ON FLOOR

SNo	TYPE	WIDTH	HEIGHT	MATERIAL	LOCATION
1.	D1	1050	2400	WOODEN	BASMENT -1
2.	D21	212	2400	2 PLY FIRE RATED	BASMENT -2
3.	D22	212	2400	ALUMINIUM	BASMENT -2
4.	D23	212	2400	2 PLY FIRE RATED	BASMENT -2
5.	D24	212	2400	ALUMINIUM	BASMENT -2
6.	D25	212	2400	2 PLY FIRE RATED	BASMENT -2
7.	D26	212	2400	ALUMINIUM	BASMENT -2
8.	D27	212	2400	2 PLY FIRE RATED	BASMENT -2
9.	D28	212	2400	ALUMINIUM	BASMENT -2
10.	D29	212	2400	2 PLY FIRE RATED	BASMENT -2
11.	D30	212	2400	ALUMINIUM	BASMENT -2
12.	D31	212	2400	2 PLY FIRE RATED	BASMENT -2
13.	D32	212	2400	ALUMINIUM	BASMENT -2
14.	D33	212	2400	2 PLY FIRE RATED	BASMENT -2
15.	D34	212	2400	ALUMINIUM	BASMENT -2
16.	D35	212	2400	2 PLY FIRE RATED	BASMENT -2
17.	D36	212	2400	ALUMINIUM	BASMENT -2

NO. SIZES FOR SUMP

1. 300/450mm WIRE DRAIN CHANNEL (EXCISE 1:300) TYPICAL
2. 150mm WIRE DRAIN CHANNEL (EXCISE 1:300) TYPICAL
3. 150mm WIRE DRAIN CHANNEL (EXCISE 1:300) TYPICAL
4. 150mm WIRE DRAIN CHANNEL (EXCISE 1:300) TYPICAL
5. 150mm WIRE DRAIN CHANNEL (EXCISE 1:300) TYPICAL
6. 150mm WIRE DRAIN CHANNEL (EXCISE 1:300) TYPICAL
7. 150mm WIRE DRAIN CHANNEL (EXCISE 1:300) TYPICAL
8. 150mm WIRE DRAIN CHANNEL (EXCISE 1:300) TYPICAL
9. 150mm WIRE DRAIN CHANNEL (EXCISE 1:300) TYPICAL
10. 150mm WIRE DRAIN CHANNEL (EXCISE 1:300) TYPICAL
11. 150mm WIRE DRAIN CHANNEL (EXCISE 1:300) TYPICAL
12. 150mm WIRE DRAIN CHANNEL (EXCISE 1:300) TYPICAL
13. 150mm WIRE DRAIN CHANNEL (EXCISE 1:300) TYPICAL
14. 150mm WIRE DRAIN CHANNEL (EXCISE 1:300) TYPICAL
15. 150mm WIRE DRAIN CHANNEL (EXCISE 1:300) TYPICAL
16. 150mm WIRE DRAIN CHANNEL (EXCISE 1:300) TYPICAL
17. 150mm WIRE DRAIN CHANNEL (EXCISE 1:300) TYPICAL

NO. SIZES FOR SUMP

1. 300/450mm WIRE DRAIN CHANNEL (EXCISE 1:300) TYPICAL
2. 150mm WIRE DRAIN CHANNEL (EXCISE 1:300) TYPICAL
3. 150mm WIRE DRAIN CHANNEL (EXCISE 1:300) TYPICAL
4. 150mm WIRE DRAIN CHANNEL (EXCISE 1:300) TYPICAL
5. 150mm WIRE DRAIN CHANNEL (EXCISE 1:300) TYPICAL
6. 150mm WIRE DRAIN CHANNEL (EXCISE 1:300) TYPICAL
7. 150mm WIRE DRAIN CHANNEL (EXCISE 1:300) TYPICAL
8. 150mm WIRE DRAIN CHANNEL (EXCISE 1:300) TYPICAL
9. 150mm WIRE DRAIN CHANNEL (EXCISE 1:300) TYPICAL
10. 150mm WIRE DRAIN CHANNEL (EXCISE 1:300) TYPICAL
11. 150mm WIRE DRAIN CHANNEL (EXCISE 1:300) TYPICAL
12. 150mm WIRE DRAIN CHANNEL (EXCISE 1:300) TYPICAL
13. 150mm WIRE DRAIN CHANNEL (EXCISE 1:300) TYPICAL
14. 150mm WIRE DRAIN CHANNEL (EXCISE 1:300) TYPICAL
15. 150mm WIRE DRAIN CHANNEL (EXCISE 1:300) TYPICAL
16. 150mm WIRE DRAIN CHANNEL (EXCISE 1:300) TYPICAL
17. 150mm WIRE DRAIN CHANNEL (EXCISE 1:300) TYPICAL

NO. SIZES FOR SUMP

1. 300/450mm WIRE DRAIN CHANNEL (EXCISE 1:300) TYPICAL
2. 150mm WIRE DRAIN CHANNEL (EXCISE 1:300) TYPICAL
3. 150mm WIRE DRAIN CHANNEL (EXCISE 1:300) TYPICAL
4. 150mm WIRE DRAIN CHANNEL (EXCISE 1:300) TYPICAL
5. 150mm WIRE DRAIN CHANNEL (EXCISE 1:300) TYPICAL
6. 150mm WIRE DRAIN CHANNEL (EXCISE 1:300) TYPICAL
7. 150mm WIRE DRAIN CHANNEL (EXCISE 1:300) TYPICAL
8. 150mm WIRE DRAIN CHANNEL (EXCISE 1:300) TYPICAL
9. 150mm WIRE DRAIN CHANNEL (EXCISE 1:300) TYPICAL
10. 150mm WIRE DRAIN CHANNEL (EXCISE 1:300) TYPICAL
11. 150mm WIRE DRAIN CHANNEL (EXCISE 1:300) TYPICAL
12. 150mm WIRE DRAIN CHANNEL (EXCISE 1:300) TYPICAL
13. 150mm WIRE DRAIN CHANNEL (EXCISE 1:300) TYPICAL
14. 150mm WIRE DRAIN CHANNEL (EXCISE 1:300) TYPICAL
15. 150mm WIRE DRAIN CHANNEL (EXCISE 1:300) TYPICAL
16. 150mm WIRE DRAIN CHANNEL (EXCISE 1:300) TYPICAL
17. 150mm WIRE DRAIN CHANNEL (EXCISE 1:300) TYPICAL

NO. SIZES FOR SUMP

1. 300/450mm WIRE DRAIN CHANNEL (EXCISE 1:300) TYPICAL
2. 150mm WIRE DRAIN CHANNEL (EXCISE 1:300) TYPICAL
3. 150mm WIRE DRAIN CHANNEL (EXCISE 1:300) TYPICAL
4. 150mm WIRE DRAIN CHANNEL (EXCISE 1:300) TYPICAL
5. 150mm WIRE DRAIN CHANNEL (EXCISE 1:300) TYPICAL
6. 150mm WIRE DRAIN CHANNEL (EXCISE 1:300) TYPICAL
7. 150mm WIRE DRAIN CHANNEL (EXCISE 1:300) TYPICAL
8. 150mm WIRE DRAIN CHANNEL (EXCISE 1:300) TYPICAL
9. 150mm WIRE DRAIN CHANNEL (EXCISE 1:300) TYPICAL
10. 150mm WIRE DRAIN CHANNEL (EXCISE 1:300) TYPICAL
11. 150mm WIRE DRAIN CHANNEL (EXCISE 1:300) TYPICAL
12. 150mm WIRE DRAIN CHANNEL (EXCISE 1:300) TYPICAL
13. 150mm WIRE DRAIN CHANNEL (EXCISE 1:300) TYPICAL
14. 150mm WIRE DRAIN CHANNEL (EXCISE 1:300) TYPICAL
15. 150mm WIRE DRAIN CHANNEL (EXCISE 1:300) TYPICAL
16. 150mm WIRE DRAIN CHANNEL (EXCISE 1:300) TYPICAL
17. 150mm WIRE DRAIN CHANNEL (EXCISE 1:300) TYPICAL

NO. SIZES FOR SUMP

1. 300/450mm WIRE DRAIN CHANNEL (EXCISE 1:300) TYPICAL
2. 150mm WIRE DRAIN CHANNEL (EXCISE 1:300) TYPICAL
3. 150mm WIRE DRAIN CHANNEL (EXCISE 1:300) TYPICAL
4. 150mm WIRE DRAIN CHANNEL (EXCISE 1:300) TYPICAL
5. 150mm WIRE DRAIN CHANNEL (EXCISE 1:300) TYPICAL
6. 150mm WIRE DRAIN CHANNEL (EXCISE 1:300) TYPICAL
7. 150mm WIRE DRAIN CHANNEL (EXCISE 1:300) TYPICAL
8. 150mm WIRE DRAIN CHANNEL (EXCISE 1:300) TYPICAL
9. 150mm WIRE DRAIN CHANNEL (EXCISE 1:300) TYPICAL
10. 150mm WIRE DRAIN CHANNEL (EXCISE 1:300) TYPICAL
11. 150mm WIRE DRAIN CHANNEL (EXCISE 1:300) TYPICAL
12. 150mm WIRE DRAIN CHANNEL (EXCISE 1:300) TYPICAL
13. 150mm WIRE DRAIN CHANNEL (EXCISE 1:300) TYPICAL
14. 150mm WIRE DRAIN CHANNEL (EXCISE 1:300) TYPICAL
15. 150mm WIRE DRAIN CHANNEL (EXCISE 1:300) TYPICAL
16. 150mm WIRE DRAIN CHANNEL (EXCISE 1:300) TYPICAL
17. 150mm WIRE DRAIN CHANNEL (EXCISE 1:300) TYPICAL

NO. SIZES FOR SUMP

1. 300/450mm WIRE DRAIN CHANNEL (EXCISE 1:300) TYPICAL
2. 150mm WIRE DRAIN CHANNEL (EXCISE 1:300) TYPICAL
3. 150mm WIRE DRAIN CHANNEL (EXCISE 1:300) TYPICAL
4. 150mm WIRE DRAIN CHANNEL (EXCISE 1:300) TYPICAL
5. 150mm WIRE DRAIN CHANNEL (EXCISE 1:300) TYPICAL
6. 150mm WIRE DRAIN CHANNEL (EXCISE 1:300) TYPICAL
7. 150mm WIRE DRAIN CHANNEL (EXCISE 1:300) TYPICAL
8. 150mm WIRE DRAIN CHANNEL (EXCISE 1:300) TYPICAL
9. 150mm WIRE DRAIN CHANNEL (EXCISE 1:300) TYPICAL
10. 150mm WIRE DRAIN CHANNEL (EXCISE 1:300) TYPICAL
11. 150mm WIRE DRAIN CHANNEL (EXCISE 1:300) TYPICAL
12. 150mm WIRE DRAIN CHANNEL (EXCISE 1:300) TYPICAL
13. 150mm WIRE DRAIN CHANNEL (EXCISE 1:300) TYPICAL
14. 150mm WIRE DRAIN CHANNEL (EXCISE 1:300) TYPICAL
15. 150mm WIRE DRAIN CHANNEL (EXCISE 1:300) TYPICAL
16. 150mm WIRE DRAIN CHANNEL (EXCISE 1:300) TYPICAL
17. 150mm WIRE DRAIN CHANNEL (EXCISE 1:300) TYPICAL