

Note :-

- BUILDING WILL BE DESIGNED (STRUCTURES) AS PER RELEVANT IS CODES FOR EARTH QUAKE RESISTANCE.
- THE BUILDING IS ARTIFICIALLY LIT AND MECHANICALLY VENTILATED.

LEGEND:-

PROJECT :

REVISED BUILDING PLANS OF GROUP HOUSING COLONY AREA MEASURING 25.087 ACRES (LICENCE NO. 123 OF 2012 DATED 20-12-2012 IN SECTOR-63, GURGAON BEING DEVELOPED BY ARJIE BUILDERS & DEVELOPERS PVT. LTD. AND OTHERS IN COLLABORATION WITH DLF HOME DEVELOPERS LTD (DEARLER KNOWN AS DLF NEW GURGAON HOME DEVELOPERS PVT.LTD)

ARCHITECTURE:
ARCOP

ARCOP ASSOCIATES PVT LTD
Plot No. 36B, Sector-32, Institutional Area, Gurgaon, Haryana, 122001, India
Tel: 91-124-4595500
91-124-4595500
Fax: 91-124-4595550

TO BE READ WITH THIS OFFICE MEMO NO. 34-1
DATED: 06.01.2023

ARCHITECTS SEAL & SIGNATURE
RISHABH BHATTARAI
MCA, IIAA
ARCHITECT

OWNER'S SEAL & SIGNATURE
DLF Home Developers Limited
Authorized Signatory

JAN.-2023 Scale : 1:100
Drawing Title:-
REFUGEE FLOOR PLAN & AREA CALCULATION
TOWER-D

REFUGEE AREA CALCULATION (17TH, 26TH & 35TH FLOOR TOWER-D)	
REFUGEE - A	1.15 X 1.30 = 1.495
REFUGEE - B	1.15 X 1.30 = 1.495
REFUGEE - C	1.15 X 1.30 = 1.495
REFUGEE - D	1.15 X 1.30 = 1.495
REFUGEE - E	1.15 X 1.30 = 1.495
REFUGEE - F	1.15 X 1.30 = 1.495
REFUGEE - G	1.15 X 1.30 = 1.495
REFUGEE - H	1.15 X 1.30 = 1.495
REFUGEE - I	1.15 X 1.30 = 1.495
REFUGEE - J	1.15 X 1.30 = 1.495
REFUGEE - K	1.15 X 1.30 = 1.495
REFUGEE - L	1.15 X 1.30 = 1.495
REFUGEE - M	1.15 X 1.30 = 1.495
REFUGEE - N	1.15 X 1.30 = 1.495
REFUGEE - O	1.15 X 1.30 = 1.495
REFUGEE - P	1.15 X 1.30 = 1.495
REFUGEE - Q	1.15 X 1.30 = 1.495
REFUGEE - R	1.15 X 1.30 = 1.495
REFUGEE - S	1.15 X 1.30 = 1.495
REFUGEE - T	1.15 X 1.30 = 1.495
REFUGEE - U	1.15 X 1.30 = 1.495
REFUGEE - V	1.15 X 1.30 = 1.495
REFUGEE - W	1.15 X 1.30 = 1.495
REFUGEE - X	1.15 X 1.30 = 1.495
REFUGEE - Y	1.15 X 1.30 = 1.495
REFUGEE - Z	1.15 X 1.30 = 1.495
TOTAL	2.990

REFUGEE AREA CALCULATION OF 17TH, 26TH & 35TH FLOOR (TOWER-D)

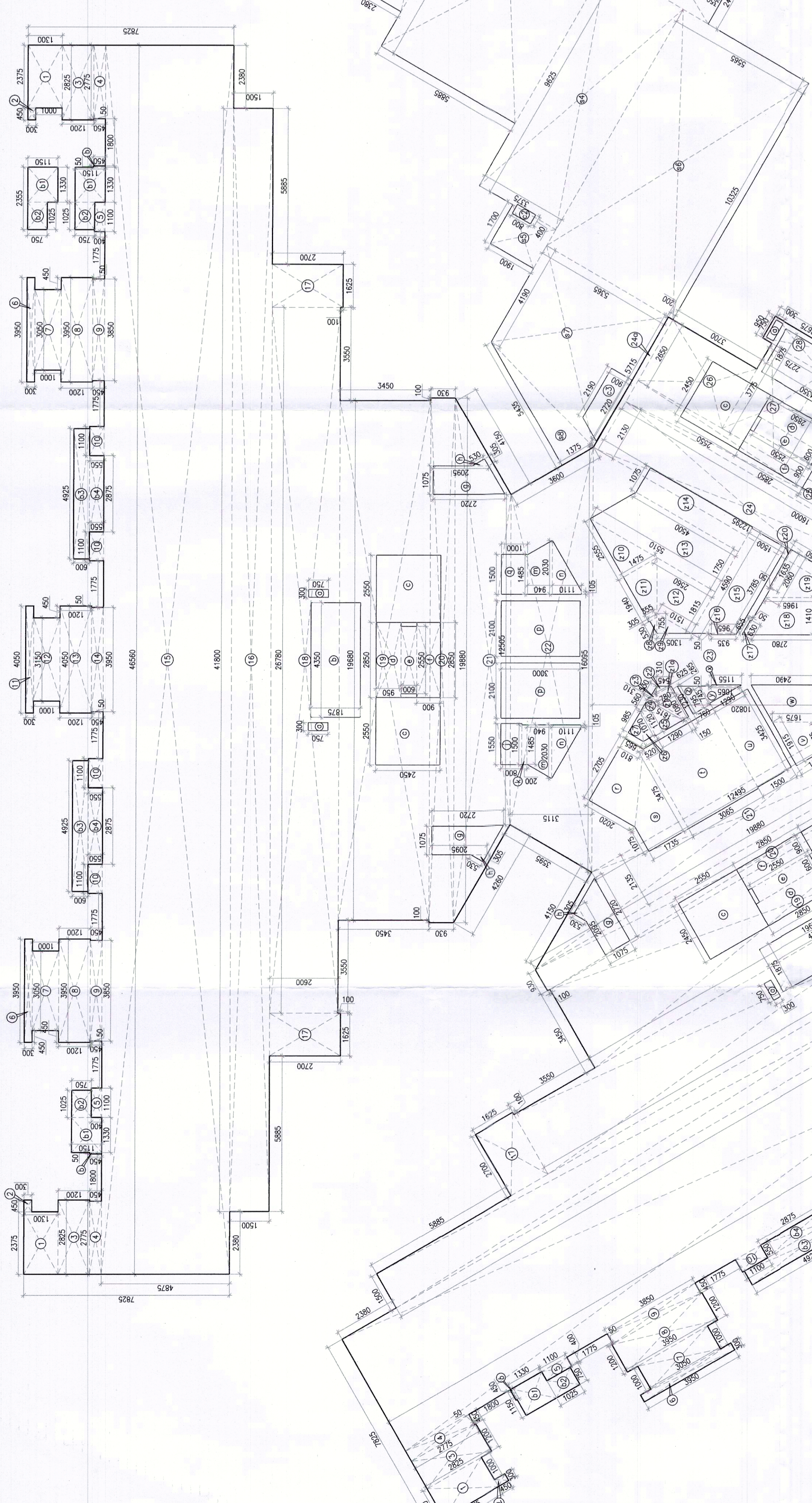

REFUGEE TYPICAL FLOOR PLAN (17th, 26th & 35th FLOOR PLAN) (TOWER-D)

AREA CALCULATION OF 17TH, 26TH & 35TH FLOOR TOWER-D	
REFUGEE - A	1.15 X 1.30 = 1.495
REFUGEE - B	1.15 X 1.30 = 1.495
REFUGEE - C	1.15 X 1.30 = 1.495
REFUGEE - D	1.15 X 1.30 = 1.495
REFUGEE - E	1.15 X 1.30 = 1.495
REFUGEE - F	1.15 X 1.30 = 1.495
REFUGEE - G	1.15 X 1.30 = 1.495
REFUGEE - H	1.15 X 1.30 = 1.495
REFUGEE - I	1.15 X 1.30 = 1.495
REFUGEE - J	1.15 X 1.30 = 1.495
REFUGEE - K	1.15 X 1.30 = 1.495
REFUGEE - L	1.15 X 1.30 = 1.495
REFUGEE - M	1.15 X 1.30 = 1.495
REFUGEE - N	1.15 X 1.30 = 1.495
REFUGEE - O	1.15 X 1.30 = 1.495
REFUGEE - P	1.15 X 1.30 = 1.495
REFUGEE - Q	1.15 X 1.30 = 1.495
REFUGEE - R	1.15 X 1.30 = 1.495
REFUGEE - S	1.15 X 1.30 = 1.495
REFUGEE - T	1.15 X 1.30 = 1.495
REFUGEE - U	1.15 X 1.30 = 1.495
REFUGEE - V	1.15 X 1.30 = 1.495
REFUGEE - W	1.15 X 1.30 = 1.495
REFUGEE - X	1.15 X 1.30 = 1.495
REFUGEE - Y	1.15 X 1.30 = 1.495
REFUGEE - Z	1.15 X 1.30 = 1.495
TOTAL	2.990

SCHEDULE OF OPENING IN GLASS	
1. DW	2875 X 9000
2. SWH	19500 X 5000
3. ST	350 X 2500
4. OT	1500 X 2500
5. ST	1200 X 2500
6. SW	1200 X 2500
7. SW	1500 X 2500
8. SW	1500 X 2500
9. OT	2000 X 2500
10. OT	1500 X 4000
11. SW	1375 X 5000
12. SW	1775 X 5000
13. SW	2400 X 5000
14. SW	2400 X 5000
15. SW	2400 X 5000
16. SW	2400 X 5000
17. SW	4000 X 5000
18. SW	4500 X 5000
19. SW	5500 X 5000
20. SW	5700 X 5000
21. SW	5700 X 5000
22. SW	2400 X 900
23. SW	1000 X 2500
24. SW	1000 X 2500
25. SW	1000 X 2500
26. SW	1000 X 2500
27. SW	1000 X 2500
28. SW	1000 X 2500
29. SW	1000 X 2500
30. SW	1000 X 2500
31. SW	1000 X 2500
32. SW	1000 X 2500
33. SW	1000 X 2500
34. SW	1000 X 2500
35. SW	1000 X 2500
36. SW	1000 X 2500
37. SW	1000 X 2500
38. SW	1000 X 2500
39. SW	1000 X 2500
40. SW	1000 X 2500
41. SW	1000 X 2500
42. SW	1000 X 2500
43. SW	1000 X 2500
44. SW	1000 X 2500
45. SW	1000 X 2500
46. SW	1000 X 2500
47. SW	1000 X 2500
48. SW	1000 X 2500
49. SW	1000 X 2500
50. SW	1000 X 2500
51. SW	1000 X 2500
52. SW	1000 X 2500
53. SW	1000 X 2500
54. SW	1000 X 2500
55. SW	1000 X 2500
56. SW	1000 X 2500
57. SW	1000 X 2500
58. SW	1000 X 2500
59. SW	1000 X 2500
60. SW	1000 X 2500
61. SW	1000 X 2500
62. SW	1000 X 2500
63. SW	1000 X 2500
64. SW	1000 X 2500
65. SW	1000 X 2500
66. SW	1000 X 2500
67. SW	1000 X 2500
68. SW	1000 X 2500
69. SW	1000 X 2500
70. SW	1000 X 2500
71. SW	1000 X 2500
72. SW	1000 X 2500
73. SW	1000 X 2500
74. SW	1000 X 2500
75. SW	1000 X 2500
76. SW	1000 X 2500
77. SW	1000 X 2500
78. SW	1000 X 2500
79. SW	1000 X 2500
80. SW	1000 X 2500
81. SW	1000 X 2500
82. SW	1000 X 2500
83. SW	1000 X 2500
84. SW	1000 X 2500
85. SW	1000 X 2500
86. SW	1000 X 2500
87. SW	1000 X 2500
88. SW	1000 X 2500
89. SW	1000 X 2500
90. SW	1000 X 2500
91. SW	1000 X 2500
92. SW	1000 X 2500
93. SW	1000 X 2500
94. SW	1000 X 2500
95. SW	1000 X 2500
96. SW	1000 X 2500
97. SW	1000 X 2500
98. SW	1000 X 2500
99. SW	1000 X 2500
100. SW	1000 X 2500

PIPE ELEVATION LEGEND	
1. DW	2875 X 9000
2. SWH	19500 X 5000
3. ST	350 X 2500
4. OT	1500 X 2500
5. ST	1200 X 2500
6. SW	1200 X 2500
7. SW	1500 X 2500
8. SW	1500 X 2500
9. OT	2000 X 2500
10. OT	1500 X 4000
11. SW	1375 X 5000
12. SW	1775 X 5000
13. SW	2400 X 5000
14. SW	2400 X 5000
15. SW	2400 X 5000
16. SW	2400 X 5000
17. SW	4000 X 5000
18. SW	4500 X 5000
19. SW	5500 X 5000
20. SW	5700 X 5000
21. SW	5700 X 5000
22. SW	2400 X 900
23. SW	1000 X 2500
24. SW	1000 X 2500
25. SW	1000 X 2500
26. SW	1000 X 2500
27. SW	1000 X 2500
28. SW	1000 X 2500
29. SW	1000 X 2500
30. SW	1000 X 2500
31. SW	1000 X 2500
32. SW	1000 X 2500
33. SW	1000 X 2500
34. SW	1000 X 2500
35. SW	1000 X 2500
36. SW	1000 X 2500
37. SW	1000 X 2500
38. SW	1000 X 2500
39. SW	1000 X 2500
40. SW	1000 X 2500
41. SW	1000 X 2500
42. SW	1000 X 2500
43. SW	1000 X 2500
44. SW	1000 X 2500
45. SW	1000 X 2500
46. SW	1000 X 2500
47. SW	1000 X 2500
48. SW	1000 X 2500
49. SW	1000 X 2500
50. SW	1000 X 2500
51. SW	1000 X 2500
52. SW	1000 X 2500
53. SW	1000 X 2500
54. SW	1000 X 2500
55. SW	1000 X 2500
56. SW	1000 X 2500
57. SW	1000 X 2500
58. SW	1000 X 2500
59. SW	1000 X 2500
60. SW	1000 X 2500
61. SW	1000 X 2500
62. SW	1000 X 2500
63. SW	1000 X 2500
64. SW	1000 X 2500
65. SW	1000 X 2500
66. SW	1000 X 2500
67. SW	1000 X 2500
68. SW	1000 X 2500
69. SW	1000 X 2500
70. SW	1000 X 2500
71. SW	1000 X 2500
72. SW	1000 X 2500
73. SW	1000 X 2500
74. SW	1000 X 2500
75. SW	1000 X 2500
76. SW	1000 X 2500
77. SW	1000 X 2500
78. SW	1000 X 2500
79. SW	1000 X 2500
80. SW	1000 X 2500
81. SW	1000 X 2500
82. SW	1000 X 2500
83. SW	1000 X 2500
84. SW	1000 X 2500
85. SW	1000 X 2500
86. SW	1000 X 2500
87. SW	1000 X 2500
88. SW	1000 X 2500
89. SW	1000 X 2500
90. SW	1000 X 2500
91. SW	1000 X 2500
92. SW	1000 X 2500
93. SW	1000 X 2500
94. SW	1000 X 2500
95. SW	1000 X 2500
96. SW	1000 X 2500
97. SW	1000 X 2500
98. SW	1000 X 2500
99. SW	1000 X 2500
100. SW	1000 X 2500