

Note:-

- BUILDING HAS AUTOMATIC SPRINKLER SYSTEM WHEREVER REQUIRED BY NBC.
- BUILDING WILL BE DESIGNED (STRUCTURES) AS PER RELEVANT IS CODES FOR EARTH QUAKE RESISTANCE.
- BUILDING IS ARTIFICIALLY LIGHTED MECHANICALLY VENTILATED / AIRCONDITIONED & 100% POWER BACKUP

LEGEND:-

PROJECT:

REVISED BUILDING PLAN (REVISION-1) OF SUMMIT PLAZA DEVELOPMENT (ITD) POLICY DATED 30/02/2018 ON THE AREA MEASURING 2.85 ACRES FALLING IN RESIDENTIAL CUM GROUP HOUSING COLONY (NAMELY DLF-5 FORMERLY KNOWN AS DLF PHASE-V), GURGRAM BEING DEVELOPED BY DLF LIMITED.

DESIGN ARCHITECTS

ARCOP

ARCOP ASSOCIATES PVT LTD
 Plot No. 36B, Sector-32, Institutional Area,
 Gurgaon, Haryana - 122001, India
 Tel: 91-124-4995500
 Fax: 91-124-4995550
 ASSOCIATE ARCHITECTS

RISIMIS ARCHITECTS

RSMS ARCHITECTS PVT. LTD.
 69, Nara Nivas, Bhowani Kunj
 (Behind D2), Vasant Kunj,
 New Delhi-110070
 Tel: 011-26898616, 26898617
 WWW.RSMS-GRG.COM

This is a PROFESSIONAL BUILDING PLAN approved as per the provisions of the applicable laws and regulations.

APPROVED BY: [Signatures]

MEMBER BPAC

TO BE READ WITH THIS SURVEY DRAWING.

ARCHITECT'S SEAL & SIGNATURE

OWNER'S SEAL & SIGNATURE

JAN-2024 Scale - 1:100 Drawing No - R-05

Drawing Title - 4TH FLOOR PLAN

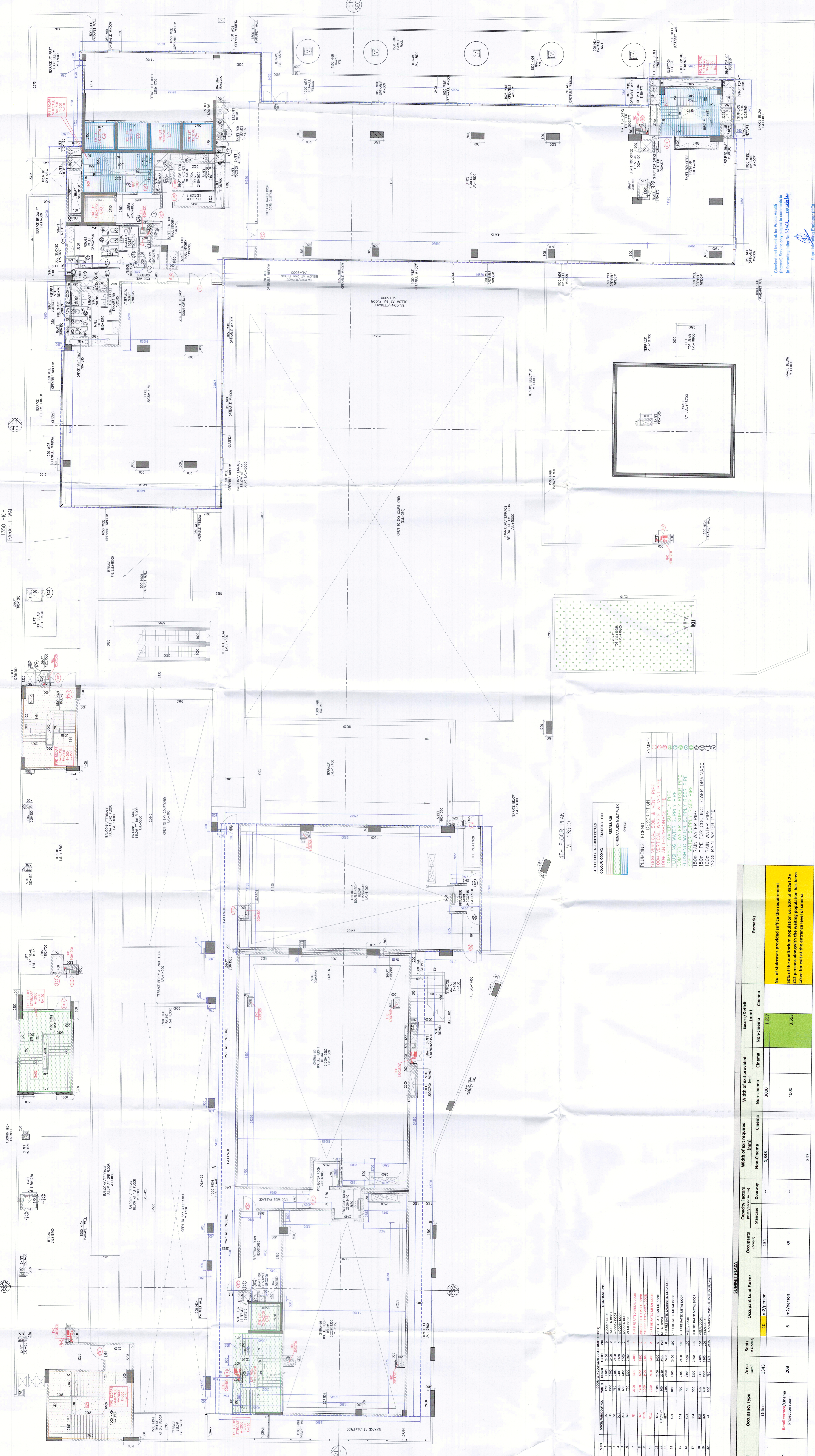

4TH FLOOR PLAN
 LVL: L4-18500

NO.	ROOM / SERVICE AREA	AREA (sqm)	LOAD (kg/sqm)	LOAD (kN)	REMARKS
1	OFFICE	1200	150	180	
2	OFFICE	1000	150	150	
3	OFFICE	1100	150	165	
4	OFFICE	1300	150	195	
5	OFFICE	1400	150	210	
6	OFFICE	1500	150	225	
7	OFFICE	1600	150	240	
8	OFFICE	1700	150	255	
9	OFFICE	1800	150	270	
10	OFFICE	1900	150	285	
11	OFFICE	2000	150	300	
12	OFFICE	2100	150	315	
13	OFFICE	2200	150	330	
14	OFFICE	2300	150	345	
15	OFFICE	2400	150	360	
16	OFFICE	2500	150	375	
17	OFFICE	2600	150	390	
18	OFFICE	2700	150	405	
19	OFFICE	2800	150	420	
20	OFFICE	2900	150	435	
21	OFFICE	3000	150	450	
22	OFFICE	3100	150	465	
23	OFFICE	3200	150	480	
24	OFFICE	3300	150	495	
25	OFFICE	3400	150	510	
26	OFFICE	3500	150	525	
27	OFFICE	3600	150	540	
28	OFFICE	3700	150	555	
29	OFFICE	3800	150	570	
30	OFFICE	3900	150	585	
31	OFFICE	4000	150	600	
32	OFFICE	4100	150	615	
33	OFFICE	4200	150	630	
34	OFFICE	4300	150	645	
35	OFFICE	4400	150	660	
36	OFFICE	4500	150	675	
37	OFFICE	4600	150	690	
38	OFFICE	4700	150	705	
39	OFFICE	4800	150	720	
40	OFFICE	4900	150	735	
41	OFFICE	5000	150	750	
42	OFFICE	5100	150	765	
43	OFFICE	5200	150	780	
44	OFFICE	5300	150	795	
45	OFFICE	5400	150	810	
46	OFFICE	5500	150	825	
47	OFFICE	5600	150	840	
48	OFFICE	5700	150	855	
49	OFFICE	5800	150	870	
50	OFFICE	5900	150	885	
51	OFFICE	6000	150	900	
52	OFFICE	6100	150	915	
53	OFFICE	6200	150	930	
54	OFFICE	6300	150	945	
55	OFFICE	6400	150	960	
56	OFFICE	6500	150	975	
57	OFFICE	6600	150	990	
58	OFFICE	6700	150	1005	
59	OFFICE	6800	150	1020	
60	OFFICE	6900	150	1035	
61	OFFICE	7000	150	1050	
62	OFFICE	7100	150	1065	
63	OFFICE	7200	150	1080	
64	OFFICE	7300	150	1095	
65	OFFICE	7400	150	1110	
66	OFFICE	7500	150	1125	
67	OFFICE	7600	150	1140	
68	OFFICE	7700	150	1155	
69	OFFICE	7800	150	1170	
70	OFFICE	7900	150	1185	
71	OFFICE	8000	150	1200	
72	OFFICE	8100	150	1215	
73	OFFICE	8200	150	1230	
74	OFFICE	8300	150	1245	
75	OFFICE	8400	150	1260	
76	OFFICE	8500	150	1275	
77	OFFICE	8600	150	1290	
78	OFFICE	8700	150	1305	
79	OFFICE	8800	150	1320	
80	OFFICE	8900	150	1335	
81	OFFICE	9000	150	1350	
82	OFFICE	9100	150	1365	
83	OFFICE	9200	150	1380	
84	OFFICE	9300	150	1395	
85	OFFICE	9400	150	1410	
86	OFFICE	9500	150	1425	
87	OFFICE	9600	150	1440	
88	OFFICE	9700	150	1455	
89	OFFICE	9800	150	1470	
90	OFFICE	9900	150	1485	
91	OFFICE	10000	150	1500	

4TH FLOOR PLAN
 LVL: L4-18500

SYMBOL	DESCRIPTION
1	100% VERTICAL SOLE & VENT PIPE
2	100% ANTI-SYDNORASE PIPE
3	100% ANTI-SYDNORASE PIPE
4	DOMESTIC WATER SUPPLY RIBBE PIPE
5	DOMESTIC WATER SUPPLY RIBBE PIPE
6	150MM RAIN WATER PIPE
7	150MM RAIN WATER PIPE
8	100MM RAIN WATER PIPE
9	100MM RAIN WATER PIPE
10	200MM RAIN WATER PIPE
11	200MM RAIN WATER PIPE
12	100MM RAIN WATER PIPE
13	100MM RAIN WATER PIPE
14	100MM RAIN WATER PIPE
15	100MM RAIN WATER PIPE
16	100MM RAIN WATER PIPE
17	100MM RAIN WATER PIPE
18	100MM RAIN WATER PIPE
19	100MM RAIN WATER PIPE
20	100MM RAIN WATER PIPE
21	100MM RAIN WATER PIPE
22	100MM RAIN WATER PIPE
23	100MM RAIN WATER PIPE
24	100MM RAIN WATER PIPE
25	100MM RAIN WATER PIPE
26	100MM RAIN WATER PIPE
27	100MM RAIN WATER PIPE
28	100MM RAIN WATER PIPE
29	100MM RAIN WATER PIPE
30	100MM RAIN WATER PIPE
31	100MM RAIN WATER PIPE
32	100MM RAIN WATER PIPE
33	100MM RAIN WATER PIPE
34	100MM RAIN WATER PIPE
35	100MM RAIN WATER PIPE
36	100MM RAIN WATER PIPE
37	100MM RAIN WATER PIPE
38	100MM RAIN WATER PIPE
39	100MM RAIN WATER PIPE
40	100MM RAIN WATER PIPE
41	100MM RAIN WATER PIPE
42	100MM RAIN WATER PIPE
43	100MM RAIN WATER PIPE
44	100MM RAIN WATER PIPE
45	100MM RAIN WATER PIPE
46	100MM RAIN WATER PIPE
47	100MM RAIN WATER PIPE
48	100MM RAIN WATER PIPE
49	100MM RAIN WATER PIPE
50	100MM RAIN WATER PIPE
51	100MM RAIN WATER PIPE
52	100MM RAIN WATER PIPE
53	100MM RAIN WATER PIPE
54	100MM RAIN WATER PIPE
55	100MM RAIN WATER PIPE
56	100MM RAIN WATER PIPE
57	100MM RAIN WATER PIPE
58	100MM RAIN WATER PIPE
59	100MM RAIN WATER PIPE
60	100MM RAIN WATER PIPE
61	100MM RAIN WATER PIPE
62	100MM RAIN WATER PIPE
63	100MM RAIN WATER PIPE
64	100MM RAIN WATER PIPE
65	100MM RAIN WATER PIPE
66	100MM RAIN WATER PIPE
67	100MM RAIN WATER PIPE
68	100MM RAIN WATER PIPE
69	100MM RAIN WATER PIPE
70	100MM RAIN WATER PIPE
71	100MM RAIN WATER PIPE
72	100MM RAIN WATER PIPE
73	100MM RAIN WATER PIPE
74	100MM RAIN WATER PIPE
75	100MM RAIN WATER PIPE
76	100MM RAIN WATER PIPE
77	100MM RAIN WATER PIPE
78	100MM RAIN WATER PIPE
79	100MM RAIN WATER PIPE
80	100MM RAIN WATER PIPE
81	100MM RAIN WATER PIPE
82	100MM RAIN WATER PIPE
83	100MM RAIN WATER PIPE
84	100MM RAIN WATER PIPE
85	100MM RAIN WATER PIPE
86	100MM RAIN WATER PIPE
87	100MM RAIN WATER PIPE
88	100MM RAIN WATER PIPE
89	100MM RAIN WATER PIPE
90	100MM RAIN WATER PIPE
91	100MM RAIN WATER PIPE
92	100MM RAIN WATER PIPE
93	100MM RAIN WATER PIPE
94	100MM RAIN WATER PIPE
95	100MM RAIN WATER PIPE
96	100MM RAIN WATER PIPE
97	100MM RAIN WATER PIPE
98	100MM RAIN WATER PIPE
99	100MM RAIN WATER PIPE
100	100MM RAIN WATER PIPE

Level	Occupancy Type	Area (sqm)	Seas (sqm)	Occupant Load Factor	Capacity Factors (Number of persons)		Width of exit required (mm)		Excess/Deficit (mm)		Remarks
					Seas	Dooney	Non-Cinema	Cinema	Non-Cinema	Cinema	
Fourth	OFFICE	1343	208	15	134	---	3,343	4000	1,637	3,653	No. of staircases provided suffices the requirement. 50% of the additional population i.e. 50% of 1324 i.e. 212 persons alongwith the existing population has been taken for exit at the entrance level of Cinema.